

- 17 Lift up the cord off the peg behind the unknotted Master Slide.
 22. Hold both cords taut and move the unknotted Master Slide by hand to its end of the track.
 23. Pull the outside cord to tighten the loop. Check to ensure the Master Slides are still centered and adjust again if necessary. Lock the cord over the peg as shown in (Fig. 18).

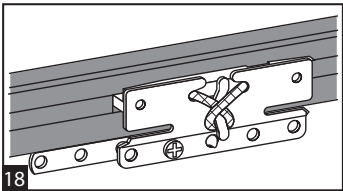

18 Adjusting the cord length and fitting the tension pulley

24. Go to the masterslide with the knotted cord ends and pull down on the right hand knot to reduce the cord loop.(Fig. 19)

To prevent the risk of child strangulation the cord loop must be 1m maximum from the rail and the tension pulley must be fitted.

NOTE: it is the responsibility of the person fitting the rail to ensure that the cord length meets the stated requirements.

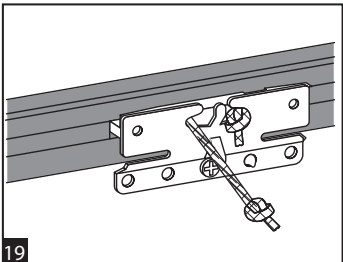

- 19 25. Using the two screws supplied, fix the tension pulley at the correct height, directly in line with the pull cord as shown (Fig. 20).

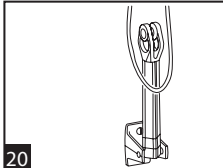

- 20 26. Extend the neck of the pulley and secure in higher position using a pin or small nail. Remove the central barrel of the pulley by pulling it down and then out (Fig. 21a). Place the cord inside the pulley and replace the barrel ensuring it clicks into place (Fig. 21b).

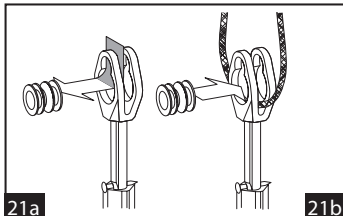

- 21a 21b 27. Take up the slack of the cord and tie a knot behind the masterslide arm. Remove the pin or nail from the pulley, the cord will now be fully tensioned. If there is insufficient tension in the cord, reduce the cord length by adjusting the knot behind the masterslide arm (Fig. 22). Cut the excess cord in front of the knot.

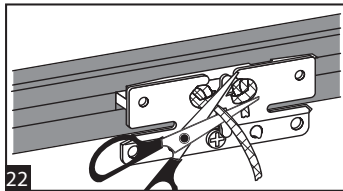

- 22 28. If the cord becomes twisted, simply rotate the head of the pulley to untwist it (Fig. 23). The curtains can now be hung.

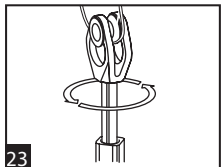

23



WARNING



It is essential that these instructions are followed to ensure the product works correctly and to prevent the risk of young children becoming entangled in the cord loop. If in doubt consult a professional fitter for advice.

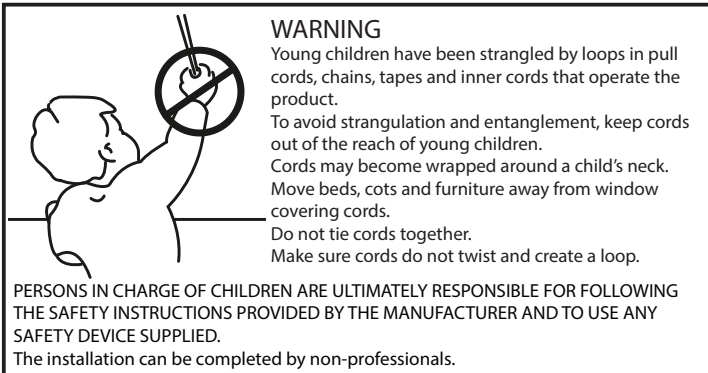

WARNING

Young children have been strangled by loops in pull cords, chains, tapes and inner cords that operate the product.

To avoid strangulation and entanglement, keep cords out of the reach of young children.

Cords may become wrapped around a child's neck. Move beds, cots and furniture away from window covering cords.

Do not tie cords together.

Make sure cords do not twist and create a loop.

PERSONS IN CHARGE OF CHILDREN ARE ULTIMATELY RESPONSIBLE FOR FOLLOWING THE SAFETY INSTRUCTIONS PROVIDED BY THE MANUFACTURER AND TO USE ANY SAFETY DEVICE SUPPLIED.

The installation can be completed by non-professionals.

Safety

- Always use a step ladder when working at heights.
- Do not over reach. Always move the step ladder so that you are in a safe working position.
- Do not hold or lean on the track to support your weight.
- Use two people for the installation of longer tracks.
- Take care when using power tools, use of a Residual Current Device (RCD) is recommended.
- Always wear eye protection when drilling.
- Check for hidden pipe runs or cables using a pipe/cable finder.

Care and Maintenance

Tracks should be wiped clean periodically with a warm damp cloth.

The track has been designed to run smoothly for many years, however, the occasional application of silicon spray to the roller glider channel will ensure continued high performance.

Sunflex, Keys Park Road, Hednesford, Cannock, WS12 2FR
 • tel: +44 (0)330 005 2233 • fax: +44(0) 1543 279505
 • email: info@swish.co.uk • web: www.swish.co.uk

Swish Ultraglide Curtain Track

Fitting Instructions

Please read these instructions carefully and check the contents of the pack against the table, before attempting to assemble and fix this product. The fixing screws supplied are for use where a wooden batten is fixed to the wall. If you intend to fix the track directly to the wall, you must use the most appropriate wall plugs and fixings.

Tools Required: Spirit level, Tape measure, Flat bladed screwdriver, Crosshead (Posidrive) screwdriver, 2mm drill bit (pilot hole for wood screws), Drill, Pencil, Step ladder.

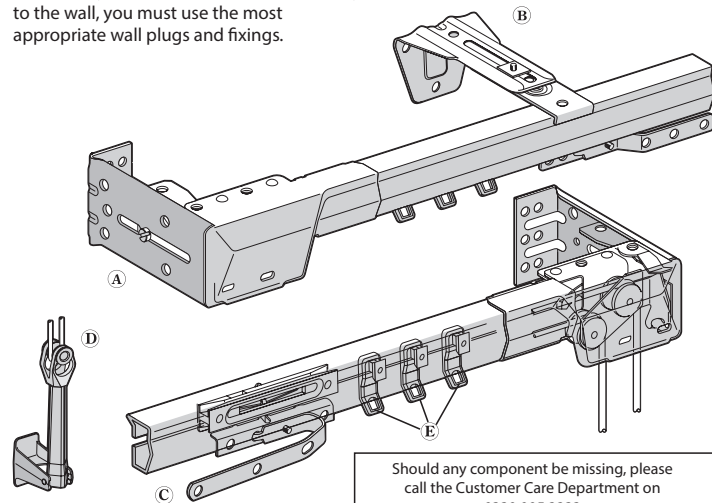

Should any component be missing, please call the Customer Care Department on 0330 005 2233

Contents ▾	Lengths▷	Lengths▷				
		1.0m to 1.75m	1.2m to 2.0m	1.75m to 3.0m	2.5m to 4.0m	3.0m to 5.5m
A Rail End Bracket		2	2	2	2	2
B Intermediate Brackets		1	1	2	3	4
C Master Slide overlap arms		2	2	2	2	2
D Tension Pulley		1	1	1	1	1
E Gliders		18	20	30	40	56

Installation and Assembly

1. Carefully remove all the packaging, taking care not to damage the track.
2. When you have decided the location of the rail mark out the position of the fixing line, 10cm above the window recess and allow 15 cm either side for the curtains to stack back as shown in Fig 1. The rail must be fitted at least 1.5m from the floor.

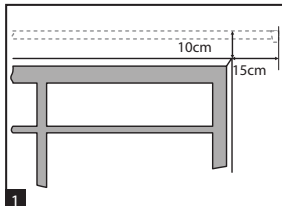

Mounting Rail end brackets

* Not Required If Ceiling Fixing*

3. Take a rail end bracket, using the small screw and separate the two parts (Fig. 2). This will make it easier to reach the screws to fix them to the batten or wall.

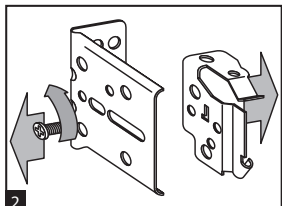

4. Use a level to ensure the holes are straight. Repeat on the other side of the window. Holding the bracket up to the fixing line, mark off the holes for the screws with a pencil (Fig. 3). If you are mounting on to a batten drill a 2mm diameter hole in the batten to a depth of 30mm.

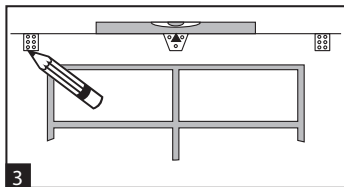

5. If fixing direct to the wall use the appropriate wall plugs & screws as shown in Fig. 4.

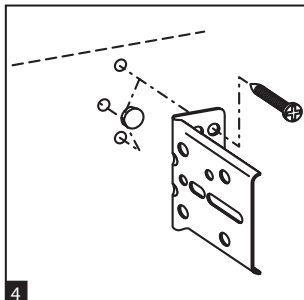

6. Reassemble the rail end bracket, ensure that the small screw is securely fixed (Fig. 5).

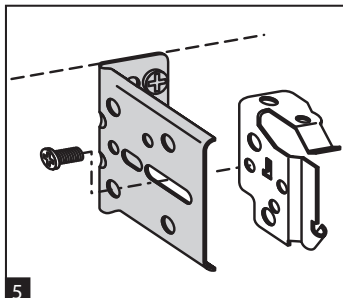

Attaching the Curtain Track

7. Once the brackets are securely fixed, insert one end of the curtain track 'projection' lug into the receiving channel of the end bracket and push the front of the track to click-close it in position (Fig. 6).

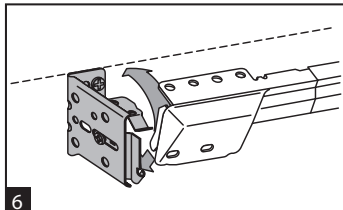

8. Repeat the procedure on the other end, you may need to extend the track.

9. You can adjust the position of the track relative to the wall by loosening the small locking screws in the end brackets and the pulling the track out to suit (Fig. 7). Re-secure the screw upon completion

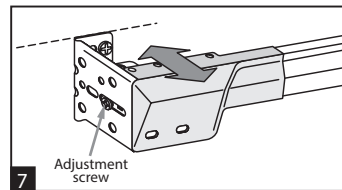

Intermediate Support Brackets

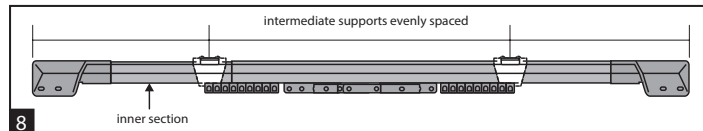

10. If you extend the curtain track horizontally by more than 30cm, you should use one or more intermediate support brackets. If you use one support bracket it should be positioned at the midpoint of the window recess. If you use more than one bracket, they should be evenly spaced along the track (Fig. 8).

11. When you have marked the position of the brackets, remove the whole track from the rail end brackets. Position the brackets in the correct position and mark the holes. If you are mounting on to a batten drill a 2mm diameter hole in the batten to a depth of 30mm.

If wall fixing use the appropriate fixings.

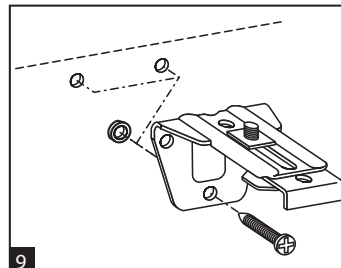

12. Re-fit the track onto the rail end brackets ensuring it fits neatly under and into the support brackets. If you need to extend the support brackets, this can be done by loosening the fastening screws underneath and pulling the bracket backwards or forwards as shown in (Fig. 10).

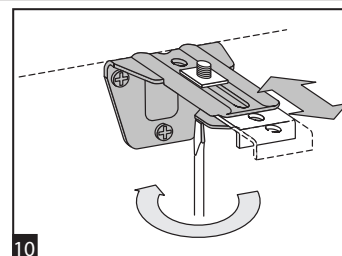

13. Underneath the support brackets you will find a locking clamp. You need a flat screwdriver to rotate the clamp (Fig. 11).

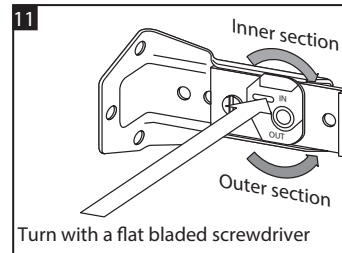

14. When you clip the bracket over the front of the outer section of the track, you must turn the locking clamp anti-clockwise. If you fit the bracket over the inner (narrower) section of the track you must turn the locking clamp clockwise to engage with the track correctly (Fig. 12).

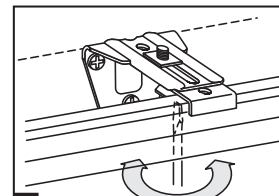

- *For ceiling fix remove the fixing plate from the support bracket and screw to the ceiling using the centre and the rear hole (Do not screw through the front hole)*

15. The track can also be mounted directly to the ceiling or batten on this section describes how to fix the track to the ceiling.

- To mount the track directly to the ceiling, position track up to the window and centralise over the window to determine correct length, Fig. 13. Remember to allow sufficient length either side to accommodate the curtains when opened and stacked back.

- For long track lengths you must fit intermediate support brackets at equal intervals along the track length.

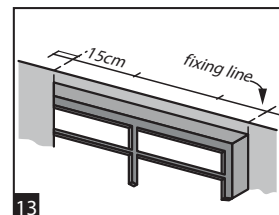

16. Position the brackets on the ceiling and mark the holes as shown, Fig. 14.

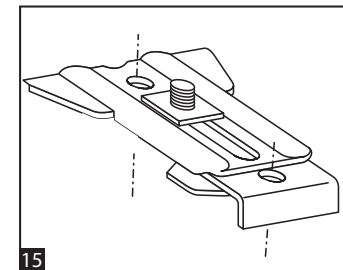
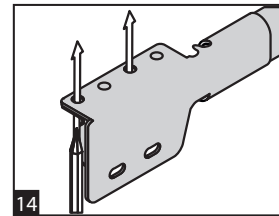

17. Fit the intermediate support clips onto the track in the fixing position and mark the holes on the ceiling, Fig. 15.

Fitting Master Slide overlap and underlap arms

18. The Master Slide arms can be repositioned if required. To do this remove the small locking screw from the Master slide overlap and underlap arms and reposition the arms as required, (Fig. 16).

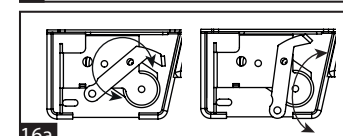
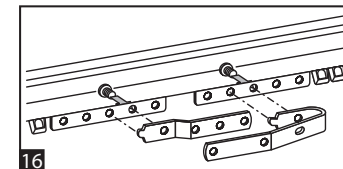

19. If required gliders can be added and removed, simply tilt the glider lock into the open position and slide the gliders onto the track. Do not forget to re-lock end pulley or the gliders will slide out of the track in use.(Fig. 16a).

Centring the Master Slides

20. Pull the inner draw cord to move the knotted Master Slide to its end of the track (Fig. 17).